



Slaley Commemoration Hall

Slaley Commemoration Hall

If you are planning a function or special event why not have it at Slaley Commemoration Hall?

Here is our guide to the hall and some ideas and inspiration...





Slaley Commemoration Hall

Table of Contents

Welcome	3
Slaley Commemoration Hall.....	4
Hiring the hall - the paperwork!	7
The Meetings Page	8
The Party and Wedding Page	9
Food and Drink.....	10
Transport	11
Local Accommodation	13





Slaley Commemoration Hall

Welcome

At Slaley Commemoration Hall we can offer you a charming, traditional venue for your event. Whether it is a business meeting, party, wedding or wake, our hall has modern facilities in a relaxed and friendly location.

The Hall has been serving the local community as a place of gathering for many varied events for over 100 years.

We have local businesses who can help from the local pubs to street food providers, taxis services and accommodation providers.

We hope you choose to have your event here at Slaley Commemoration Hall.

Best wishes,

SCH Support Team





Slaley Commemoration Hall

Slaley Commemoration Hall

There are two function rooms in the Hall: The Main Hall and Community Room. Alongside these there is a well-equipped kitchen, lobby, and toilets.

- *The Main Hall*

The main hall is 15.4 m x 7.5 m, with a maximum capacity of 120 people. It is a traditional hall with high ceiling. The windows are north and west facing. There is a catering hatch to the kitchen for serving food and drinks.

- *The Community Room.*

This is 6.95 m x 6.05 m and has a maximum capacity 30. This is a modern, light and bright room with a south facing window and patio doors facing north onto a decking and grassed area.

Access

Wheelchair access is available through the main entrance and throughout the hall, though kitchen access may be limited.

Toilets

5 unisex toilets including one with disabled and baby changing facilities are provided off the main entrance lobby.

Kitchen

The fully equipped kitchen can be used for preparing meals and snacks or just teas and coffees. There is a large 6-ring gas cooker, microwave, fridge and preparation area.

Crockery, cutlery, and glasses for 100+ place settings.





Slaley Commemoration Hall

Facilities

- The hall is licenced to serve alcohol and has an entertainments licence.
- Audio Visual facilities in the main hall including a large ceiling mounted projector and screen and console.
- Modular stage which can be configured in various shapes and sizes to meet your needs.
- Piano.
- Outside grassed area. We have gazebos available.

Parking

There is parking available outside the hall and guests can park on the roadside in the village. We only ask that guest park considerately and arrive and leave quietly.





Slaley Commemoration Hall

ESCAPE ROUTES, EMERGENCY EXITS AND EMERGENCY SIGNAGE

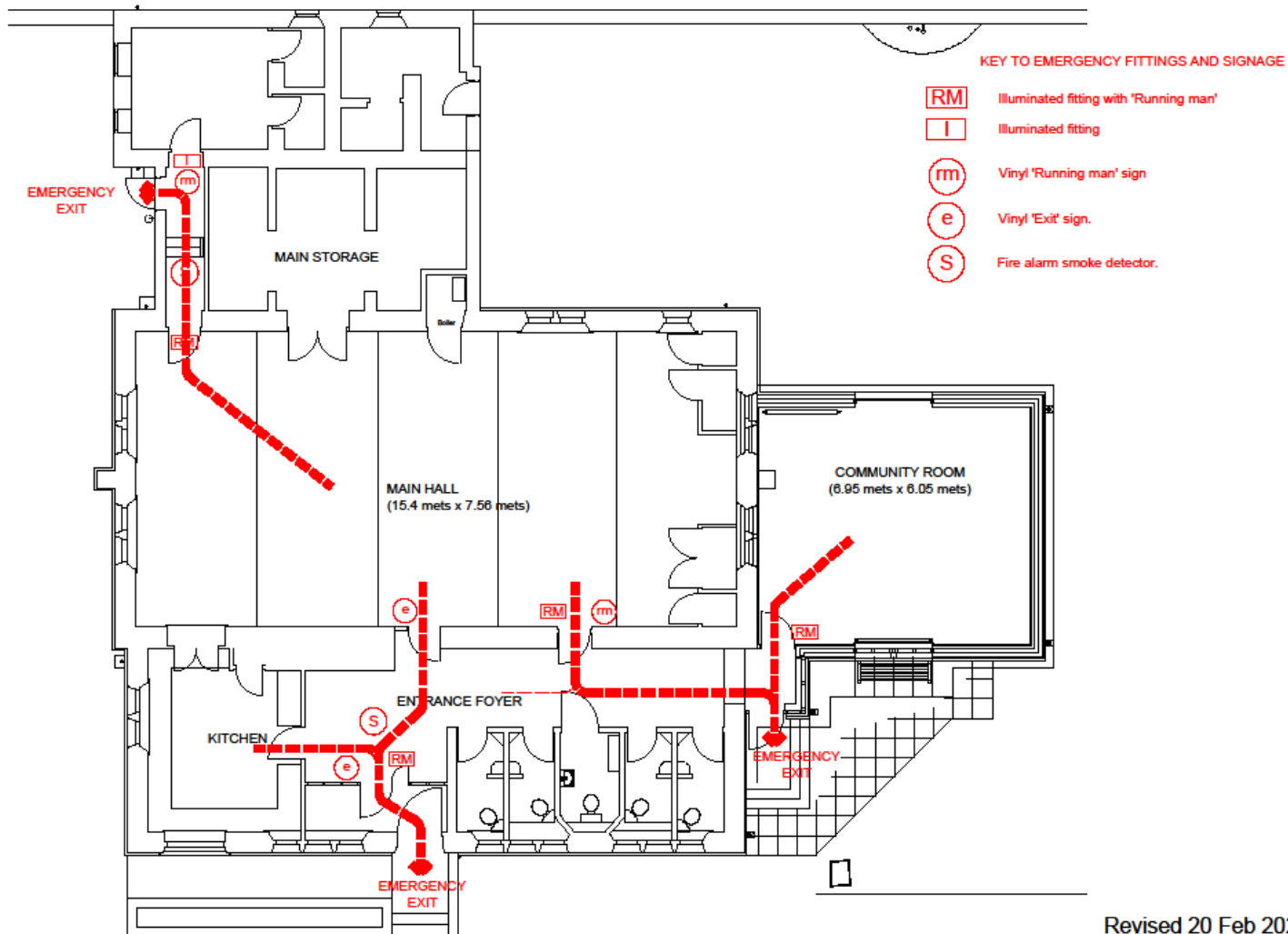



Slaley Commemoration Hall

Hiring the hall - the paperwork!

- Availability of the hall together with our Booking Form and Terms and Conditions are available on the website: www.slaley.org.uk/sch-main-page
- There you will also find additional information, policies and photos.
- Our Hire rates are also available on the web site, but please contact us directly if you would like the hall over a weekend or for an extended period and we will see what offers are available.





Slaley Commemoration Hall

The Meetings Page

Presentation Facilities

Flipcharts & pens, projection and audio-visual facilities available.

Wi-fi

Wi-fi is available throughout the building. No password required.

Catering

Hirers have use of the kitchen or refreshments can be provided on request.

Hirers typically bring lunch platters in from a local supermarket such as Morrisons or Mark & Spencer. Alternatively, please ask us for advice.

Seating

There is seating for up to 120 delegates in the Main Hall theatre style.

There are 14 tables available which will comfortably seat 6 delegates each.

The Community Room is ideal for smaller meetings of up to 18 guests around tables, though can also be set up theatre style for up to 30.

Using both the Main Hall and Community Room provides space for breakout sessions or having the refreshments/catering is a sperate room.





Slaley Commemoration Hall

The Party and Wedding Page

If you are having a wedding or renewing vows... or simply want a church blessing as part of your celebrations, our local church contact is:

Rev David Kennedy 01434 633021

Florist

Healey Flowers Bringing the natural beauty of garden and countryside to your party or wedding. Harriet 01434 682254 harriet@healeyflowers.co.uk

Event Stylist

<https://www.greatbritishbashevents.com/> Fiona Winn, who manages wedding and events was supplier and stylist for the Great British Bash near Stocksfield.

Cakes

Two local ladies will bake special cakes for your occasion.

- Anne Holmes - 01434 673641
- Margaret Ogle - 01434 673475

Decorations

Neatly Seated provide a range of products and packages including chair covers and sashes, backdrops, centre pieces candelabras and "lovelights". <http://www.neatlyseated.co.uk/>

Simply Bows and Chair covers are locally based and will also provide a range of decorations for your event. <http://www.simplybowsandchaircovers.co.uk/>

Internet sites

There is a wealth of information for functions available on the web. Below is a selection who provide links to providers in our area:



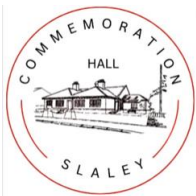

Slaley Commemoration Hall

- Hitched.co.uk
- Guidesforbrides.co.uk
- Addtoevent.co.uk
- Bark.com

Food and Drink

Traditional dining can be catered for by local providers. Today however, people often want something different... What about fire oven pizzas from one of our local providers or high-quality local pub fayre provided by one of our local inns?

Rose & Crown

www.roseandcrownsaley.co.uk

Community owned pub in the village.

Tel:01434 673996

The Traveller's Rest

Local Café and bar 01434 673231

Noisette Catering

Using locally sourced ingredients from the Tynedale area to create real food tailored to any occasion.

Daily Chef - Canapes to Cupcakes - Picnics to Dinner parties - Custom Menus to Suit All Sizes
Creative Cakes for All Occasions.

Jo Common +44 (0) 7730 799 340

jo@noisettecatering.com

Fresh 'N' Thyme – Mobile Fruit and Veg Shop

Delivered Fresh Local Produce Daily

Home and Business delivery

07710 445227 / 07464 760927





Slaley Commemoration Hall

Street Food:

- Fish and Chips: The Angel @ Corbridge 01434 632119
- Mobile Pizza oven: Fire & Dough, Hexham 07732 019187
- Greek: Acropolis <https://acropolis-street-food.co.uk/>
- Ice Cream Van: Tyne Valley Ices. 01434 673420

Bar Facility:

A tabletop bar can be set up anywhere in the hall or external bar facilities can be booked. There is a selection of wine, beer, and highball glasses at the hall.

Gin and Tonia Mobile Gin bar

Perfect for weddings, parties, corporate events and all occasions.

Tel: 07876 753115 www.ginandtonia.co.uk E: tonia@ginandtonia.co.uk

Transport

Local Taxi firms include:

Mel's Taxi Service. Based in the Shire

Airport and Rail Connections

Mobile 07949 169 191

Email: mel.silcock@live.co.uk

Pre-booking essential

All major credit cards accepted for fares over £10

Tarset Valley Taxis

4,7, & 8 seater Taxis available. Wheelchair Accessible Taxis

07711 400152 ronnieingledew@btinternet.com www.tarservalleytaxis.co.uk

Eco Cabs – Hexham

01434 600600 <https://hexham.ecocabs.com/>





Slaley Commemoration Hall

Bus Service

A daily bus service operates through the village between Hexham and Consett with onward rail and bus links from Hexham.

The timetable can be found at: <https://www.gonortheast.co.uk/services/GNE/689>





Slaley Commemoration Hall

Local Accommodation

Rose & Crown Pub & Accommodation

Phone: 01434 673996

Website: www.roseandcrownsaley.co.uk/

Slaley Hall Hotel

Phone: 01434 373350

Website: www.slaleyhallhotel.com

Rye Hill Farm, B&B, holiday Cottage and campsite: <https://ryehillfarm.co.uk/>

Pry House to the south of the village: <https://pryhousenorthumberland.co.uk/>

The Old Chapel – Holiday cottage for up to 8 guests in the heart of the village.

